

This system update introduces new features, including HVAC control, Mopeka sensor integration, TPMS, and synchronization with the AMOY BT and AMOY app.



PLEASE NOTE: This update may change your system's default settings.

We recommend reading the instructions carefully before you begin the installation process.

STEP 1.

Navigate to the A7 settings menu on the touchscreen. To enter the hidden engineering page, Tap 3-5 times on the blank area of the bottom of settings menu as highlighted in red below.

When prompted, enter the password **1000**

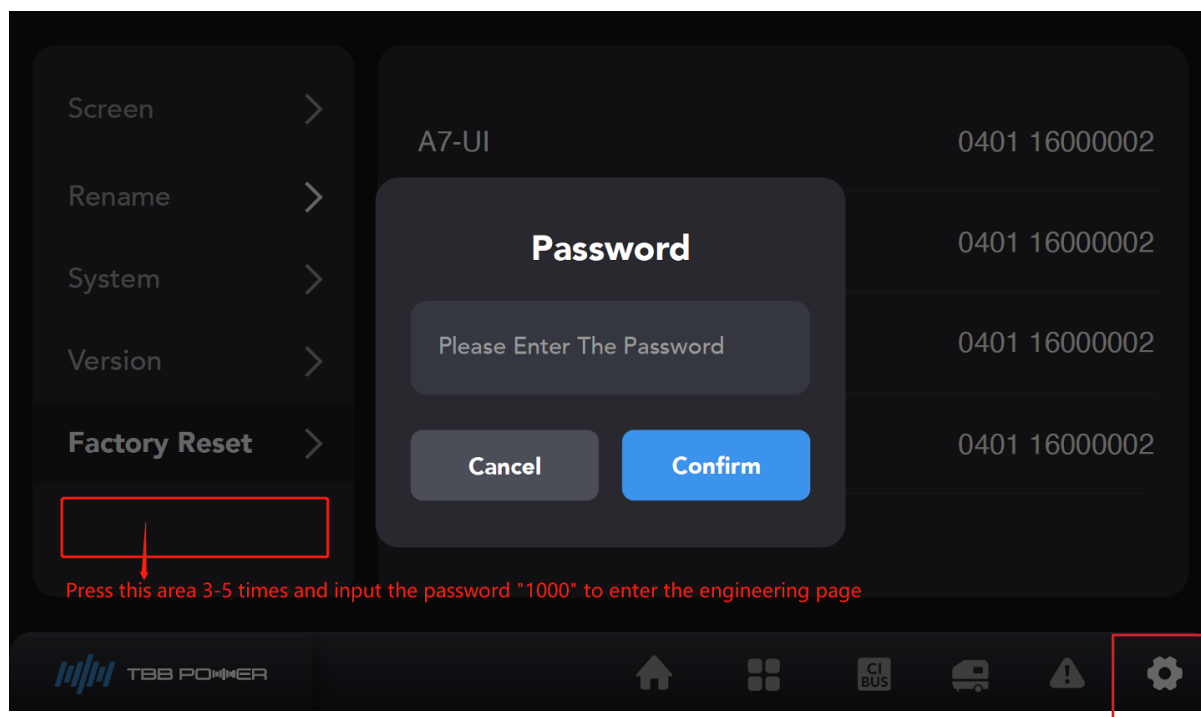

A7 settings menu

STEP 2.

Record the current system configured quantity on the following items:

- | | | |
|--|---|----------------------------------|
| <input type="checkbox"/> Inverter Charger | <input type="checkbox"/> DC module L6-2 | <input type="checkbox"/> Battery |
| <input type="checkbox"/> Alternator | <input type="checkbox"/> Slide out | <input type="checkbox"/> Awning |
| <input type="checkbox"/> MPPT solar charger controller | | |

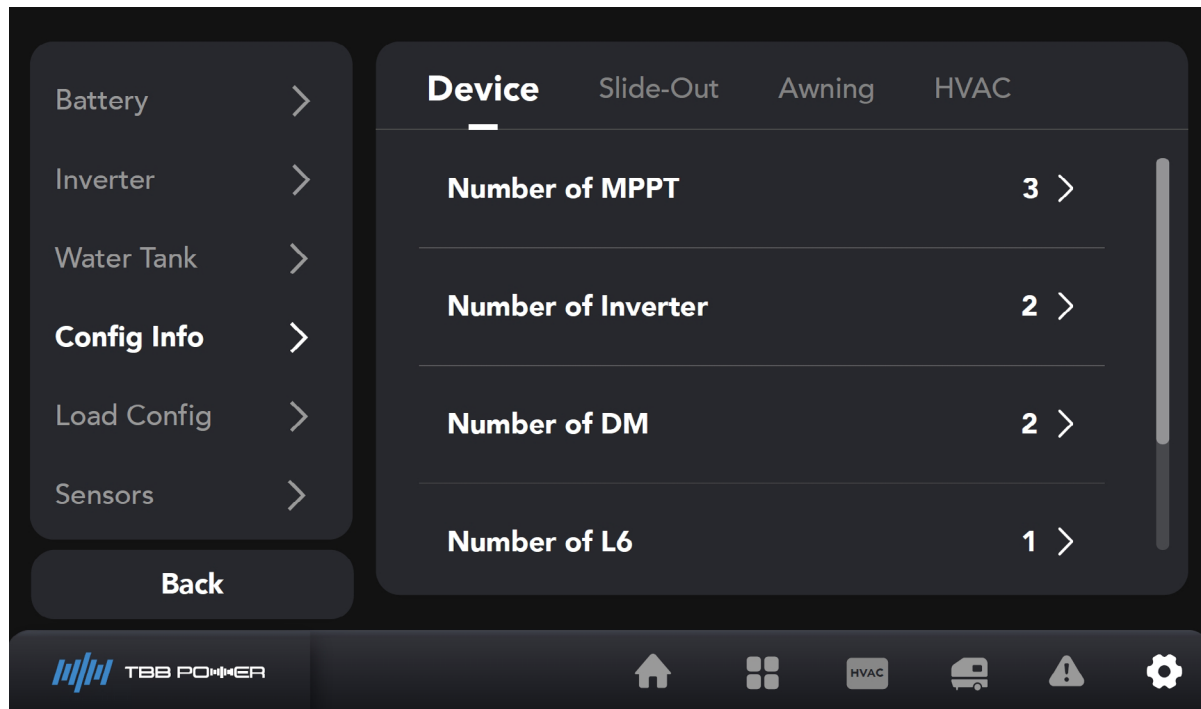

STEP 3.

Record the current inverter mode (single, split phase, or parallel) on the engineer page.

The inverter mode should be matched to the configured quantity.

Single = 1 inverter

Split phase = 2 inverters

Parallel = 2 inverters

We recommend taking notes of your key settings before updating.

If you find any discrepancies afterward, please use these notes to reconfigure.

STEP 4.

Record the system components version on the A7 version page as shown below.

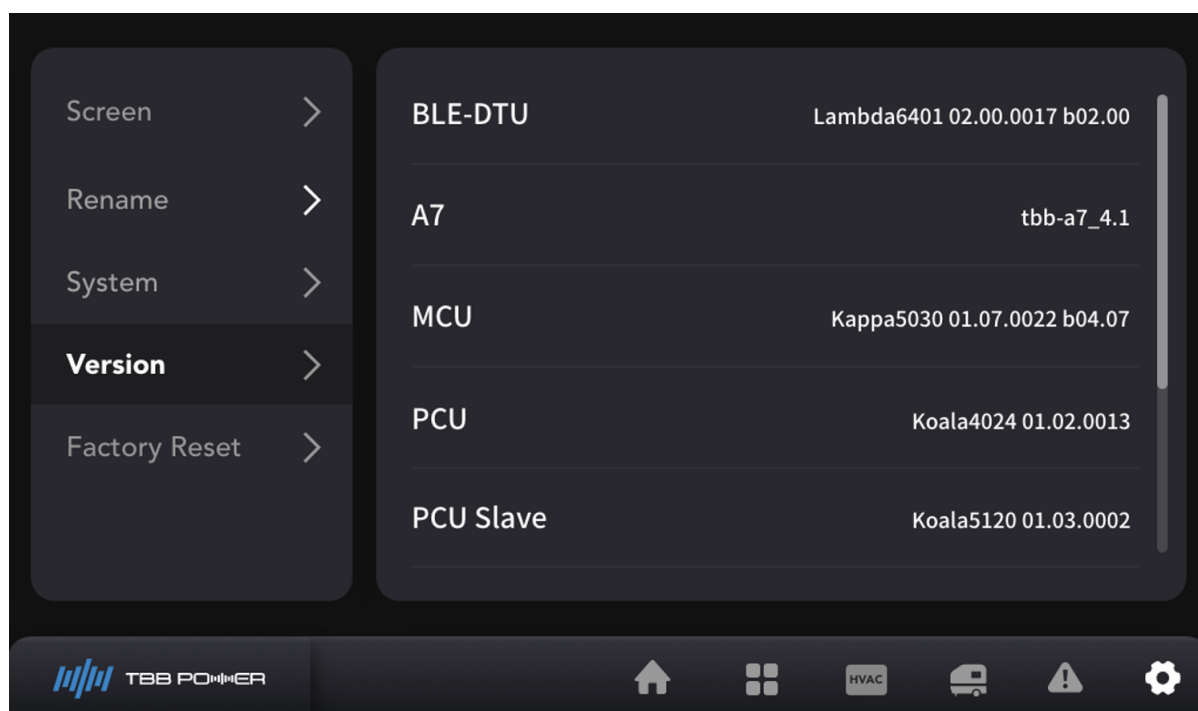

After the update finished, check the versions to verify the update success.

STEP 5.

Finish the update by following this **specific order** of updates on the AMOY BT app:

1. PCU
2. PCU Slave
3. APP (Note: update could take between 15 to 20 minutes.)
4. Conf. file

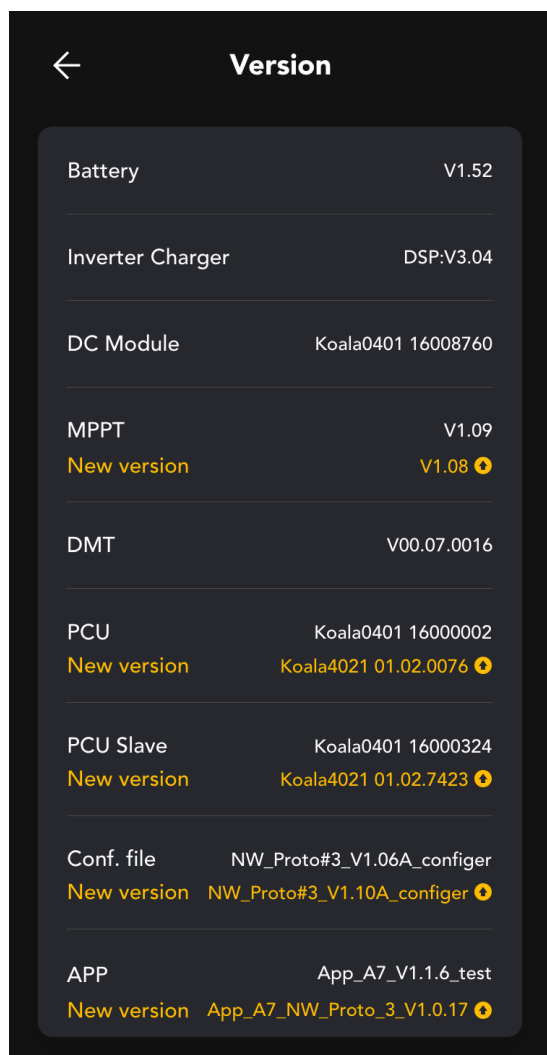

If an update is available, it will be identified in yellow.
Click on the arrow to update.

STEP 6.

A. Once all available updates are complete, reboot the system. A reboot is a complete power cycle. Turn off PV breakers, shore power, generator power, and battery disconnect for 5 seconds and then turn everything back on.

B. Check the Version page to verify all updates have been completed by comparing your version notes from STEP 4.

C. Check each component configuration to rule out any discrepancy; if the quantity is unmatched to original configuration, please modify it manually.

E. Verify the following controls are functioning:

Lighting control

Equipment control

Slide-out control

Awning control

Inverter control

Confirm system operation.

STEP 7.

We recommend updating the TBB Battery BMS.

For TBB Battery BMS instructions: www.fsi-solutions.com/future-solutions-manuals